

## MEDIA FACTSHEET – Enhancement plans for Sembawang Hot Spring Park

Sembawang Hot Spring holds many memories for the community that has used it over the years. The design of the park is shaped by the 'kampung-like' environment, and will be kept rustic with various spaces where visitors can gather and enjoy the activities in this unique park. The design will be further refined with ideas and suggestions received from the public.

### Concept design

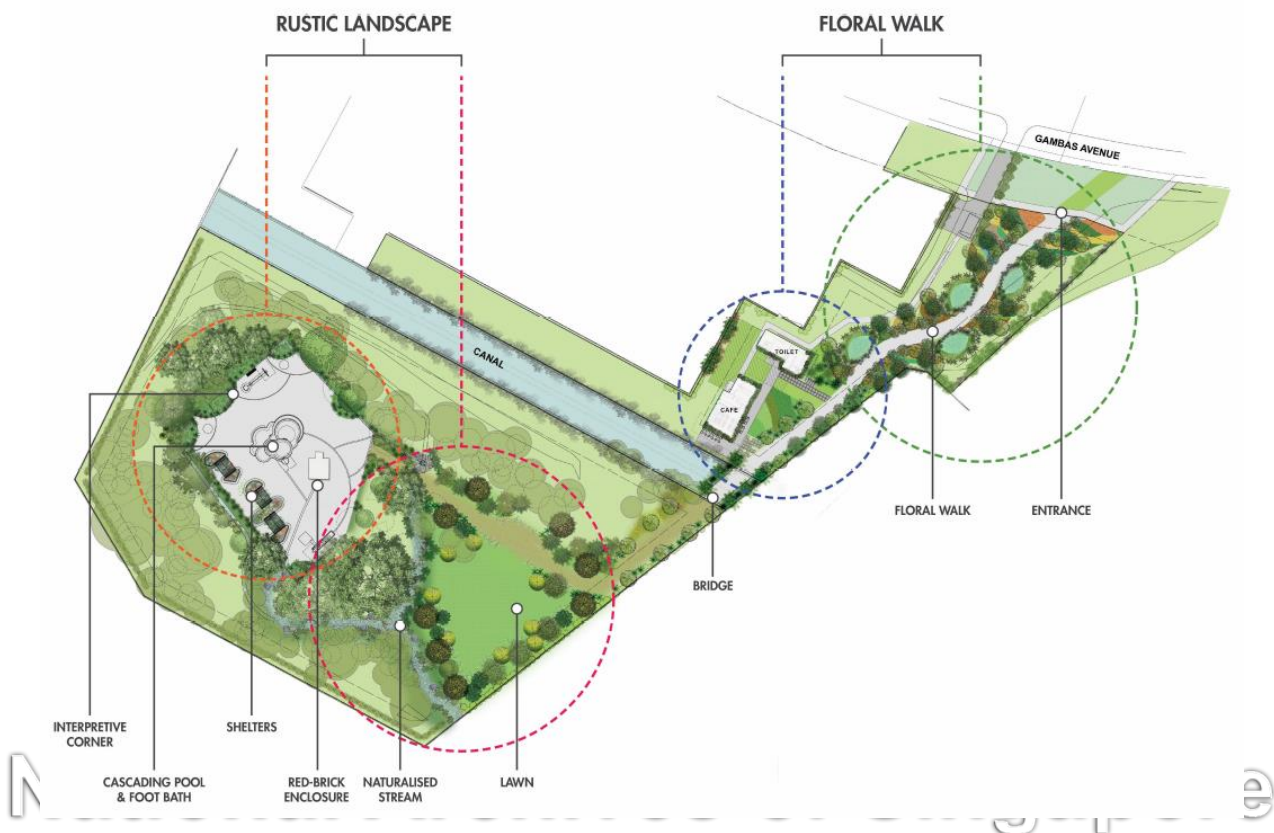

Layout of Sembawang Hot Spring Park (Courtesy of NParks)

#### Floral Walk

Park visitors are greeted by a lush floral walk comprising plants that evoke memories of our past. This includes edibles once commonly found in kampungs that visitors can now admire as they head to the café at the far end of the Floral Walk.

#### Rustic Landscape

Across the bridge from the café, visitors can experience a rustic landscape with verdant lawns, streams and unpaved paths. Naturalistic planting of a freshwater

swamp forest landscape and fruit trees surround this area, leading visitors to the hot spring.

**Key features**

Distinct and welcoming entrance, to be reminiscent of kampung gardens



Artist's impression courtesy of NParks

Lush and comfortable environment with more trees and planting that are compatible and will add to the rustic feel of the place



Artist's impression courtesy of NParks

Cascading pool where visitors can enjoy a foot bath in the hot spring water



Artist's impression courtesy of NParks

National Archives of Singapore

Area with running hot spring water for cooking eggs



Artist's impression courtesy of NParks

Water collection point which visitors can easily access



Artist's impression courtesy of NParks

Open gathering spaces next to a naturalised stream



Artist's impression courtesy of NParks

National

e

New amenities,  
including a  
washroom and  
café



Artist's impression courtesy of NParks

Sheltered seating  
areas



Artist's impression courtesy of NParks

Information boards



Artist's impression courtesy of NParks

National

e

## Plants that will be introduced

In line with the rustic character of the hot spring, the planting palette will include plants that were commonly found in kampungs in the past.

Singapore  
Rhododendron  
(*Melastoma  
malabathricum*)



Photo credit: Ang Wee Foong, NParks

Oleander  
(*Nerium oleander*)



Photo credit: Arthur Ng, NParks Flora&FaunaWeb

National Archives of Singapore

White Mussaenda  
(*Mussaenda philippica*)



Photo credit: Vicky Lim Yen Ngoh, NParks  
Flora&FaunaWeb

Rambutan  
(*Nephelium lappaceum*)



Photo credit: Ang Wee Foong, NParks

Breadfruit  
(*Artocarpus altilis*)



Photo credit: Boo Chih Min, NParks Flora&FaunaWeb

Jambu Air  
(*Syzygium aqueum*)



Photo credit: Boo Chih Min, NParks Flora&FaunaWeb

Chiku  
(*Manilkara zapota*)



Photo credit: Patricia Yap, NParks Flora&FaunaWeb

National Archives of Singapore